

# IPMECD-0267-M40

## Barrier Rod



- 4 m cylinder arm that can be used on either side of the boom gate.
- Made of aluminum alloy, and designed with anti-smashing expandable polyethylene and heat shrink sleeve.

Type	Model	Description
Barrier Rod	IPMECD-0267-M40	Barrier Rod

### Dimensions (mm[inch])

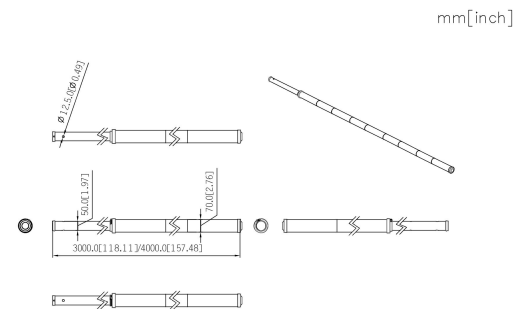

### Series Overview

The Barrier Arm has been meticulously designed with an internal round tube made of aluminum alloy, while its outer shell is wrapped in pearl cotton and a reflective film. This combination provides robust anti-smashing protection, ensuring both safety and durability.

### Technical Specification

#### Basic

Color	Red and white
Matched Product	DHI-IPMECD-2067 Series Barrier

#### General

Operating Temperature	-40 °C to +70 °C (-40 °F to +158 °F)
Storage Temperature	-40 °C to +70 °C (-40 °F to +158 °F)
Operating Humidity	10%–90% (RH), non-condensing
Storage Humidity	10%–90% (RH), non-condensing
Casing Material	Metal (Aluminum) + Expandable Polyethylene + Heat Shrink Sleeve
Product Dimensions	Φ76.0 mm × 4,000.0 mm (2.99" × 157.48")
Packaging Dimensions	4,020.0 mm × 97.0 mm × 97.0 mm (158.31" × 3.82" × 3.82") (L × W × H)
Net Weight	4.9 kg (10.80 lb)
Gross Weight	6.0 kg (13.23 lb)
Installation	Compatible with barrier installation
Anti-corrosion Level	Basic Protection *The products are designed for general use and are applicable even in areas with no specific requirements for anti-corrosion protection.

### Ordering Information